

■ UMETA ADAPTER (USA VERSION)



Adapters / elbow bodies

- elbow version 180°/45°/90°
- optionally available with square or hexagonal body
- standard version made of steel, according to SAE zinc plated, passivated and top coated
- salt spray resistance > 72 hours

GW1 thread (M)
L1 overall length
L2 thread length
W angle
SW HEX size
GW2 adapter thread (F)

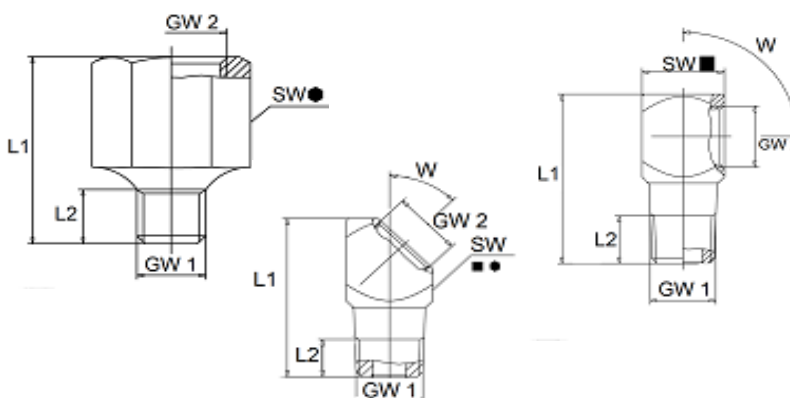

GW1 (M)		1/8" - 27 NPT/PTF				Ref.- No.:	
L1	L2	W	GW2 (F)	SW	Steel	Alemite	
1"	7/32"	45°	1/8" - 27 NPT/PTF	1/2" SQ.	■	5546134	43716
1 1/8"	17/64"	90°	1/8" - 27 NPT/PTF	1/2" SQ.	■	5546132	43706

GW1 (M)		1/4" - 28 NF/UNF/SAE				Ref.- No.:	
L1	L2	W	GW2 (F)	SW	Steel	Alemite	
3/4"	13/64"	180°	1/8"-NPTF	1/2" HEX	●	5546135	51942
13/16"	13/64"	45°	1/8"-NPTF	1/2" HEX	●	5546157	310912
1 1/32"	7/32"	90°	1/8"-NPTF	1/2" SQ.	■	5546159	51943