

## ■ UMETA TURNED PARTS ACCORDING TO SAE J-534



### Plugs

- according to SAE J-534
- for subsequent closing of boreholes
- made of steel, zinc-plated, passivated and top coated
- salt spray resistance > 72 hours

GW thread  
L1 overall length  
L2 thread length  
SW HEX size

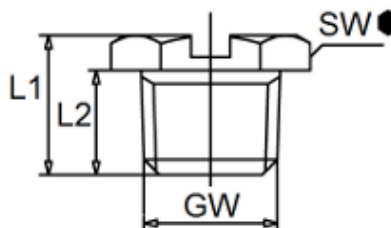

<b>GW</b>	<b>1/4"-28 UNF-2A</b>		<b>Ref.- No.:</b>		
<b>L1</b>	<b>L2</b>	<b>Thread</b>	<b>Steel</b>	<b>Alemite</b>	
1/4"	3/16"	5/16" HEX	5546138	328224	

### Plugs with Self-Forming Thread



- according to SAE J-534
- with self-forming thread
- standard version made of steel, hardened according to SAE (650HV) and yellow passivated
- salt spray resistance > 72 hours
- recommended hole size = 0.02" below nominal width

SFG thread  
L1 overall length  
L2 thread length  
SW HEX size  
X flank angle  
B Ø recommended hole size

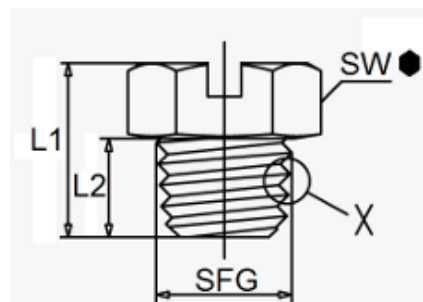

<b>SFG</b>	<b>1/4" - 28 Special Taper Thread</b>		<b>Ref.- No.:</b>		
<b>L1</b>	<b>L2</b>	<b>B Ø</b>	<b>SW</b>	<b>Steel</b>	<b>Alemite</b>
21/64"	3/16"	0.230"-0.235"	5/16" HEX	5546140	328435