

## ■ UMETA Bayonet Grease Nipples

### APPLICATION AREA

An especially strong and reliable connection with the grease nipple will be achieved by using the bayonet coupler. The construction design also results in a specific high flow-rate of grease.

Particularly suitable for the **Heavy Industry, for example Ship Building.**

### VERSIONS

In general, our bayonet nipples are made of steel, zinc-plated and passivated, and they are featured with a tapered thread.

We offer various standard types also in brass or stainless steel 1.4305 ~ ASTM 303 (V2A).

Upon request, UMETA manufactures bayonet grease nipples in other versions, with respect to the following:

- dimension
- material
- thread size
- thread form (e. g. with cylindrical thread)
- opening pressure
- etc.



### OPERATING INSTRUCTIONS

As suitable lubricating nozzle, we recommend our bayonet coupler.



## Type B1

## Bayonet Grease Nipples



- head Ø 9.9 mm
- straight version A/180°
- standard version made of steel, zinc-plated and passivated, with tapered thread
- for other types and materials, please see table, or upon request

GW thread  
L1 overall length  
L2 thread length  
SW HEX size

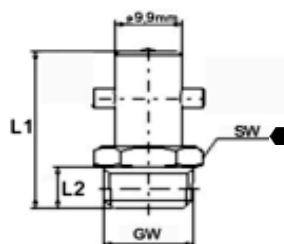

(all measures in mm,  
thread metric or in inches)

<b>GW</b>	<b>M 16 x 1.5</b>		<b>Ref.- No.:</b>			
<b>L1</b>	<b>L2</b>	<b>SW</b>	<b>Steel</b>	<b>Brass</b>	<b>SST303</b>	<b>SST316L</b>
25	6,5	17mm HEX	● 9149418			

<b>GW</b>	<b>R 1/8, 1/8 - 28 BSP</b>		<b>Ref.- No.:</b>			
<b>L1</b>	<b>L2</b>	<b>SW</b>	<b>Steel</b>	<b>Brass</b>	<b>SST303</b>	<b>SST316L</b>
24	5,5	11mm HEX	● 9149415	9155416	9157420	

<b>GW</b>	<b>R 1/4, 1/4 - 19 BSP</b>		<b>Ref.- No.:</b>			
<b>L1</b>	<b>L2</b>	<b>SW</b>	<b>Steel</b>	<b>Brass</b>	<b>SST303</b>	<b>SST316L</b>
25	6,5	14mm HEX	● 9149416	9156416	9157421	

<b>GW</b>	<b>R 3/8, 3/8 - 19 BSP</b>		<b>Ref.- No.:</b>			
<b>L1</b>	<b>L2</b>	<b>SW</b>	<b>Steel</b>	<b>Brass</b>	<b>SST303</b>	<b>SST316L</b>
25	6,5	17mm HEX	● 9149417	9157416		

<b>GW</b>	<b>1/8" - 27 NPT/PTF</b>		<b>Ref.- No.:</b>			
<b>L1</b>	<b>L2</b>	<b>SW</b>	<b>Steel</b>	<b>Brass</b>	<b>SST303</b>	<b>SST316L</b>
24	5,5	11mm HEX	● 9149414			

<b>GW</b>	<b>1/4" - 18 NPT/PTF</b>		<b>Ref.- No.:</b>			
<b>L1</b>	<b>L2</b>	<b>SW</b>	<b>Steel</b>	<b>Brass</b>	<b>SST303</b>	<b>SST316L</b>
25	6,5	14mm HEX	●	9109416		