

## Type D2



### Flush-Type Grease Nipples

- according to DIN 3405
- elbow version B/45°
- standard versions according to DIN are made of steel, zinc-plated and passivated, with tapered thread

GW thread  
L1 overall length  
L2 thread length  
SW HEX size

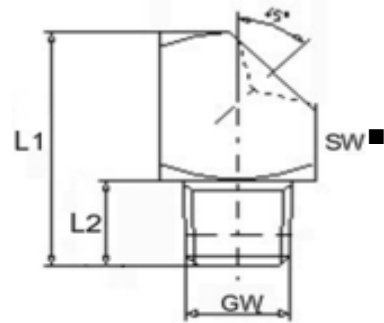

(all measures in mm,  
thread metric or in inches)

<b>GW</b>		<b>M 6 x 1.0</b>		<b>Ref.- No.:</b>				
<b>L1</b>	<b>L2</b>	<b>W</b>	<b>SW</b>	<b>Steel</b>	<b>Brass</b>	<b>SST303</b>	<b>SST316L</b>	
15	5,5	45°	9 mm SQ.	■ 3204504	3214504			

<b>GW</b>		<b>M 8 x 1.0</b>		<b>Ref.- No.:</b>				
<b>L1</b>	<b>L2</b>	<b>W</b>	<b>SW</b>	<b>Steel</b>	<b>Brass</b>	<b>SST303</b>	<b>SST316L</b>	
15	5,5	45°	9 mm SQ.	■ 3204507				

<b>GW</b>		<b>M 8 x 1.25</b>		<b>Ref.- No.:</b>				
<b>L1</b>	<b>L2</b>	<b>W</b>	<b>SW</b>	<b>Steel</b>	<b>Brass</b>	<b>SST303</b>	<b>SST316L</b>	
15	5,5	45°	9 mm SQ.	■ 3204508				

<b>GW</b>		<b>M 10 x 1.0</b>		<b>Ref.- No.:</b>				
<b>L1</b>	<b>L2</b>	<b>W</b>	<b>SW</b>	<b>Steel</b>	<b>Brass</b>	<b>SST303</b>	<b>SST316L</b>	
15	5,5	45°	11 mm SQ.	■ 3204709				

<b>GW</b>		<b>R 1/8, 1/8 - 28 BSP</b>		<b>Ref.- No.:</b>				
<b>L1</b>	<b>L2</b>	<b>W</b>	<b>SW</b>	<b>Steel</b>	<b>Brass</b>	<b>SST303</b>	<b>SST316L</b>	
15	5,5	45°	11 mm SQ.	■ 3204756				